

RE 35 Ø35 mm, Graphite Brushes, 90 Watt

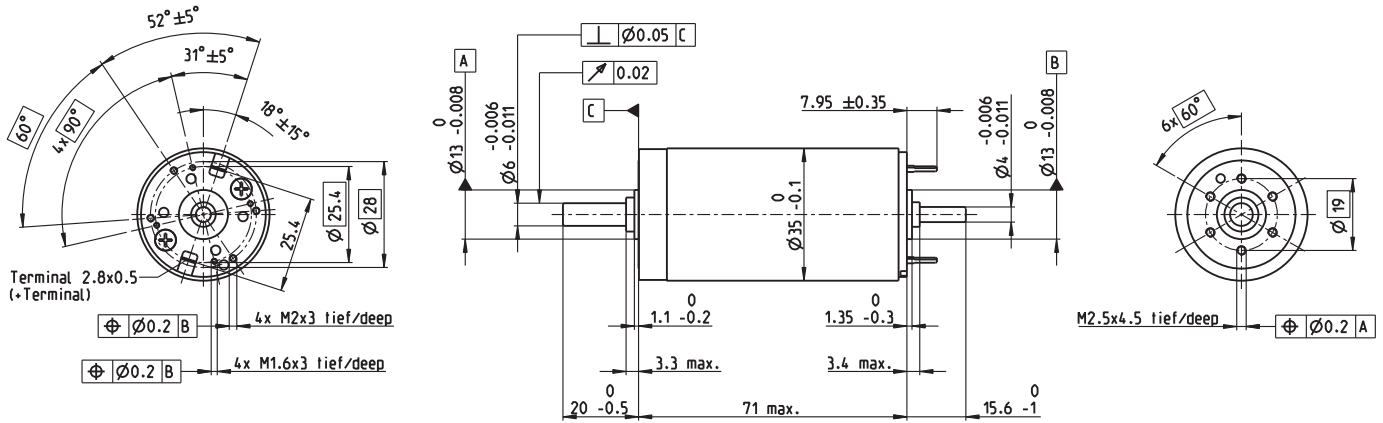

M 1:2

- Stock program
- Standard program
- Special program (on request)

Part Numbers

according to dimensional drawing
shaft length 15.6 shortened to 4 mm

273752	323890	273753	273754	273755	273756	273757	273758	273759	273760	273761	273762	273763
285785	323891	285786	285787	285788	285789	285790	285791	285792	285793	285794	285795	285796

Motor Data

Values at nominal voltage		15	24	30	42	48	48	48	48	48	48	48	48	48
1 Nominal voltage	V	15	24	30	42	48	48	48	48	48	48	48	48	48
2 No load speed	rpm	7180	7740	7270	7560	7300	6670	5980	4760	3820	3140	2580	2110	1630
3 No load current	mA	247	169	124	92.9	77.5	68.8	59.8	44.8	34.2	27.2	21.6	17.2	13
4 Nominal speed	rpm	6500	7000	6490	6820	6530	5890	5180	3940	2990	2290	1720	1230	736
5 Nominal torque (max. continuous torque)	mNm	73.1	101	97.2	101	99.4	101	101	104	106	106	106	105	105
6 Nominal current (max. continuous current)	A	4	3.62	2.62	2.02	1.67	1.55	1.39	1.14	0.928	0.761	0.626	0.507	0.393
7 Stall torque	mNm	929	1200	973	1080	980	890	776	620	498	398	322	255	196
8 Stall current	A	47.8	41.1	25	20.7	15.8	13.1	10.2	6.5	4.2	2.76	1.84	1.19	0.708
9 Max. efficiency	%	83	86	85	86	86	85	85	84	82	81	79	77	74
Characteristics		0.314	0.583	1.2	2.03	3.05	3.67	4.69	7.38	11.4	17.4	26	40.2	67.8
10 Terminal resistance	Ω	0.314	0.583	1.2	2.03	3.05	3.67	4.69	7.38	11.4	17.4	26	40.2	67.8
11 Terminal inductance	mH	0.085	0.191	0.34	0.62	0.87	1.04	1.29	2.04	3.16	4.65	6.89	10.3	17.1
12 Torque constant	mNm/A	19.4	29.2	38.9	52.5	62.2	68	75.8	95.2	119	144	175	214	276
13 Speed constant	rpm/V	491	328	246	182	154	140	126	100	80.5	66.4	54.6	44.7	34.6
14 Speed / torque gradient	rpm/mNm	7.93	6.55	7.57	7.05	7.52	7.57	7.79	7.77	7.76	8.01	8.13	8.4	8.49
15 Mechanical time constant	ms	5.65	5.44	5.4	5.35	5.34	5.35	5.35	5.36	5.36	5.37	5.38	5.39	5.41
16 Rotor inertia	gcm ²	68.1	79.2	68.1	72.5	67.9	67.4	65.6	65.9	65.9	64	63.2	61.2	60.8

Specifications

- Thermal data**
- 17 Thermal resistance housing-ambient 6.2 K/W
 - 18 Thermal resistance winding-housing 2.0 K/W
 - 19 Thermal time constant winding 30.2 s
 - 20 Thermal time constant motor 644 s
 - 21 Ambient temperature -30...+100°C
 - 22 Max. winding temperature +155°C
- Mechanical data (ball bearings)**
- 23 Max. speed 12000 rpm
 - 24 Axial play 0.05 - 0.15 mm
 - 25 Radial play 0.025 mm
 - 26 Max. axial load (dynamic) 5.6 N
 - 27 Max. force for press fits (static) 110 N
 - (static, shaft supported) 1200 N
 - 28 Max. radial load, 5 mm from flange 28 N

- Other specifications**
- 29 Number of pole pairs 1
 - 30 Number of commutator segments 13
 - 31 Weight of motor 340 g

Values listed in the table are nominal.
Explanation of the figures on page 151.

Option

- Hollow shaft as special design
- Preloaded ball bearings

Operating Range

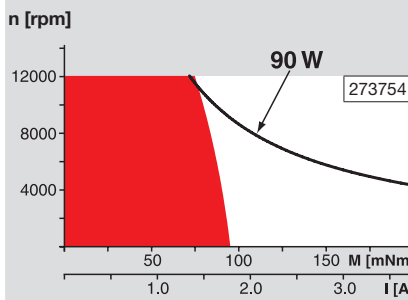

Comments

- Continuous operation**
In observation of above listed thermal resistance (lines 17 and 18) the maximum permissible winding temperature will be reached during continuous operation at 25°C ambient.
= Thermal limit.
- Short term operation**
The motor may be briefly overloaded (recurring).
- Assigned power rating**

maxon Modular System

<p>Planetary Gearhead Ø32 mm 0.75 - 6.0 Nm Page 338-344</p> <p>Planetary Gearhead Ø32 mm 4.0 - 8.0 Nm Page 345</p> <p>Planetary Gearhead Ø42 mm 3 - 15 Nm Page 349</p> <p>Spindle Drive Ø32 mm Page 370-372</p>		<p>Encoder MR 256 - 1024 CPT, 3 channels Page 393</p> <p>Encoder HED_5540 500 CPT, 3 channels Page 399/401</p> <p>DC-Tacho DCT Ø22 mm 0.52 V Page 411</p> <p>Brake AB 28 24 VDC 0.4 Nm Page 446</p> <p>End cap Page 451</p>
---	--	--

Recommended Electronics: Page 24

ESCON Mod. 50/5	417
ESCON 50/5	418
EPOS2 24/5	425
EPOS2 50/5	425
EPOS2 P 24/5	428
EPOS4 Module 50/8	431
EPOS4 Comp. 50/8 CAN	431
MAXPOS 50/5	435